



ERASMUS+ 2024/2025 REKRUTACJA

WYDZIAŁOWI KOORDYNATORZY / FACULTY COORDINATORS:

dr inż. arch. **Adam SINIECKI** incoming and outgoing students, agreements and traineeships

dr inż. arch. **Agnieszka KASIŃSKA – ANDRUSZKIEWICZ** outgoing students

dr inż. arch. **Izabela PIKLIKIEWICZ – KĘSICKA** outgoing students

mgr **Justyna URBAŃSKA-ŻAK** Dean's Office

<http://architektura.put.poznan.pl/n/erasmus/>

e-mail: erasmus.wa@put.poznan.pl

Mobility at the Faculty of Architecture

Mobilność studentów i pracowników uczelni między:

Mobility of university students and staff between:

- **Erasmus+ KA131** – krajami programu,
– program countries,
- **Erasmus+ KA171** - krajami programu i **krajami partnerskimi.**
– program and partner countries.

Short-term Mobility

Praktyki w zagranicznych biurach projektowych:

Internships in foreign design offices:

- **Erasmus+ Traineeships.**

WYDZIAŁOWI KOORDYNATORZY / FACULTY COORDINATORS:

dr inż. arch. **Adam SINIECKI**

outgoing students

dr inż. arch. **Agnieszka KASIŃSKA – ANDRUSZKIEWICZ**

dr inż. arch. **Izabela PIKLIKIEWICZ – KĘSICKA**

mgr **Justyna URBAŃSKA-ŻAK**

<http://architektura.put.poznan.pl/n/erasmus/>

e-mail: erasmus.wa@put.poznan.pl

Mobility at the Faculty of Architecture

Praktyki w zagranicznych biurach projektowych:
Internships in foreign design offices:

- **Erasmus+ Traineeships.**

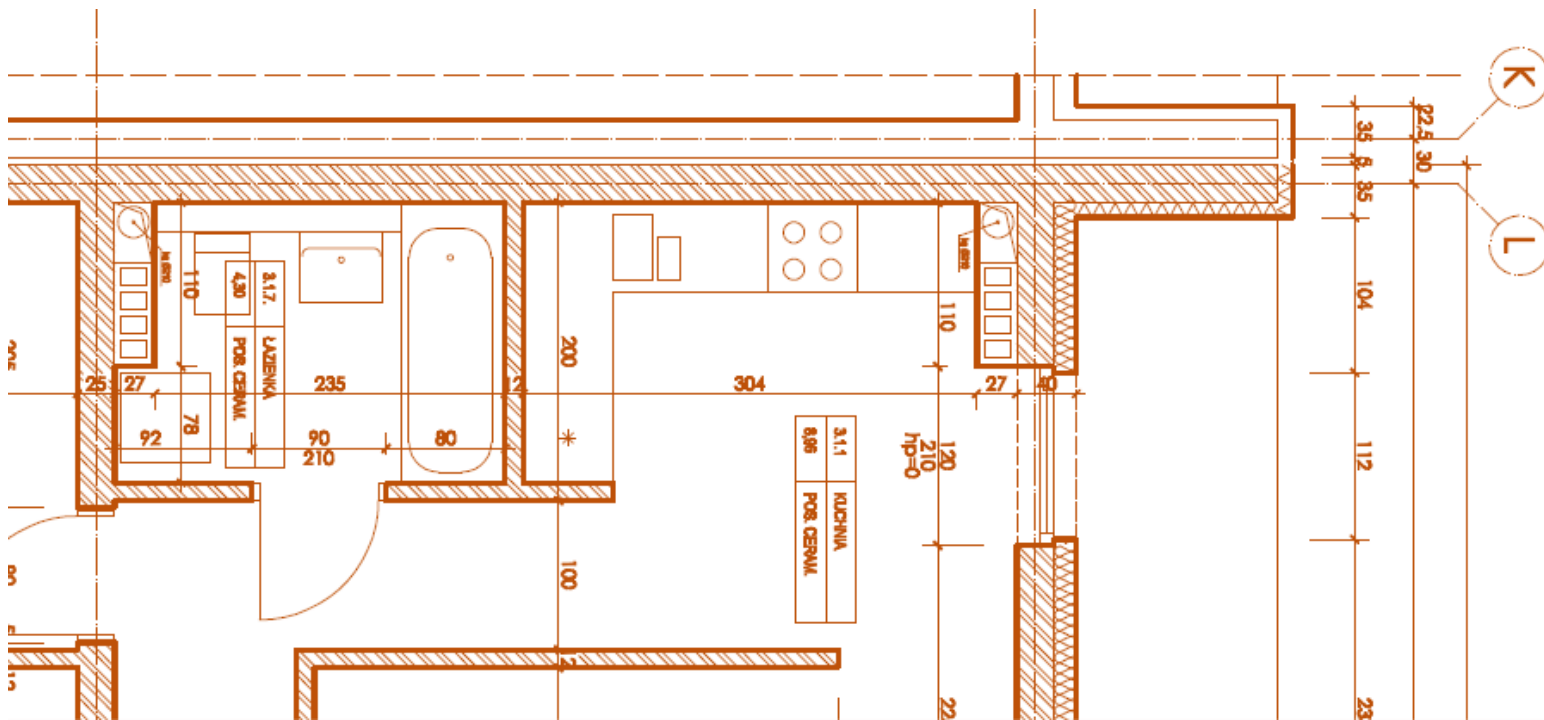

Mobility at the Faculty of Architecture

Participation of FA students in Erasmus+ in numbers.

Internship

in foreign architectural office

- ▮ Academic year 2023-24: 20 students
- ▮ Academic year 2022-23: 6 students
- ▮ Academic year 2021-22: 25 students
- ▮ Academic year 2020-21: 29 students
- ▮ Academic year 2019-20: 30 students
- ▮ Academic year 2018-19: 31 students
- ▮ Academic year 2017-18: 32 students
- ▮ Academic year 2016-17: 33 students
- ▮ Academic year 2015-16: 34 students
- ▮ Academic year 2014-15: 33 students
- ▮ Academic year 2013-14: 32 students.
- ▮ Academic year 2012-13: 36 students.

Mobility at the Faculty of Architecture

Mobilność studentów i pracowników uczelni między:
Mobility of university students and staff between:

- **Erasmus+ KA131** – krajami programu,
– program countries,



Mobility at the Faculty of Architecture

Numbers of foreign partners:

Bilateral Agreements

With Partner Faculties

- ▮ **38** Partner Universities.
- ▮ **14** countries.
- ▮ **76** places.

Statistics:

In compare to University

- ▮ **10%** of all scholarship places.
- ▮ **35% of all realized exchanges!!**
- ▮ **48% of all realized internships!!**
- ▮ **15%** of incoming students.

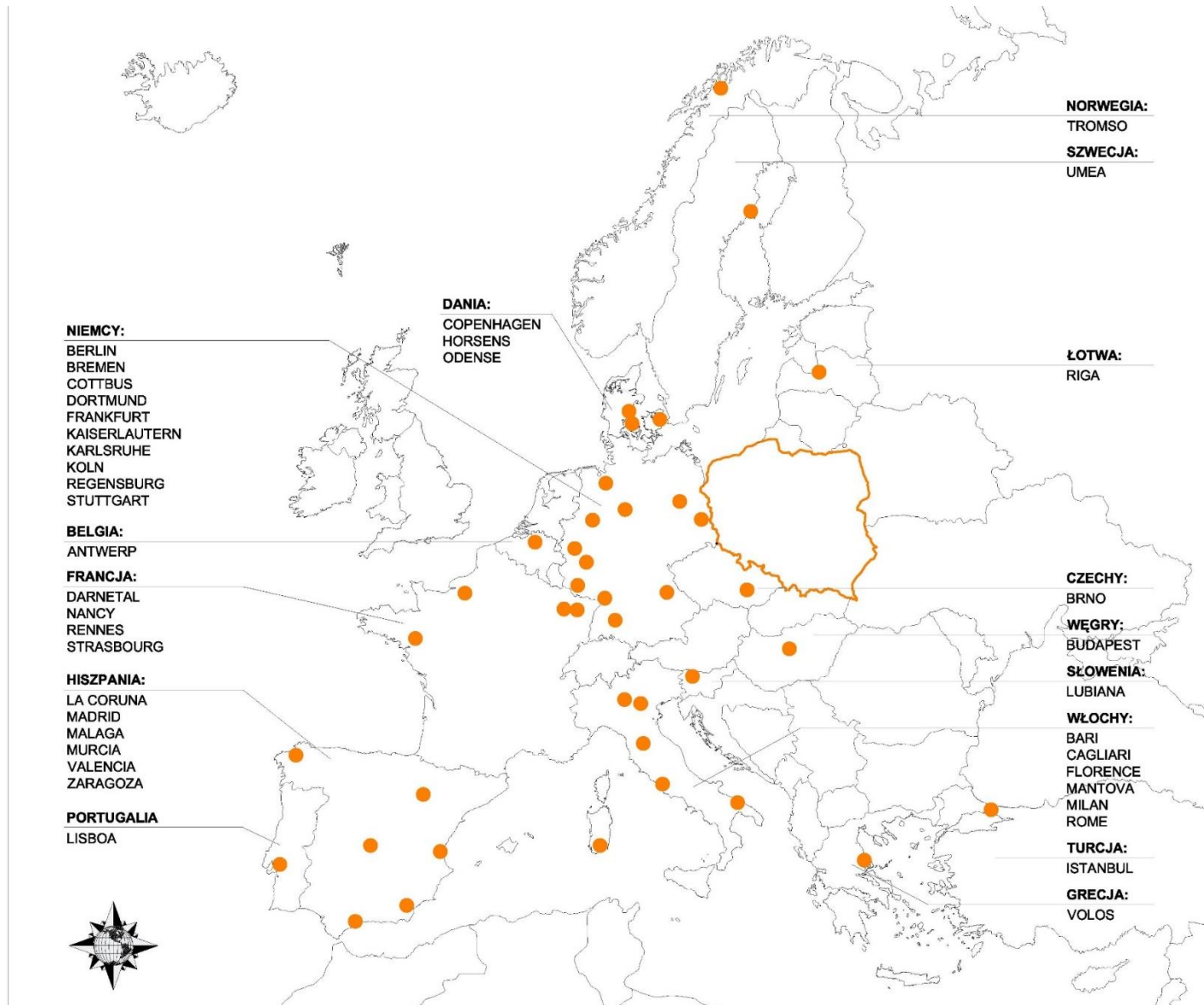

Who can go?

Study abroad

Bachelor

Students of First-cycle studies

- ▮ Students currently completing **the 3rd semester**.
- ▮ Architektura / Architecture - Study abroad on 5th and 6th semester
- ▮ Architektura Wnętrz / Interior Design – Study abroad on 5th semester
- ▮ Duration: one semester [with the option of extending your stay].
- ▮ Architektura Wnętrz – study abroad **only** 5'th semester

Master

Students of Second-cycle studies

- ▮ Students currently completing the **7th semester**.
- ▮ Study abroad on **2nd semester** [summer semester].
- ▮ Duration: **only one semester!**

How to participate?

Stages of recruitment procedure

I step Application.

- ▮ Filling out the **Application Form [AF]** with attachments and a statement „RODO”.
- ▮ **Submission by January 22, 2024** to **Dean's Office**
- ▮ **Announcement of the Ranking List** of students admitted to the recruitment process. Deadline: **until January 26, 2024.**

How to participate?

Stages of recruitment procedure

II step

Recruitment List and Statements.

- ▮ Announcement of **the nomination list** for foreign universities. Deadline: before **January 26, 2024**.
- ▮ Students signing **the Declaration of willingness** to use the place and consent to the terms of student exchange.
- ▮ Sending the Statement to the following address:
erasmus.wa@put.poznan.pl

How to participate?

Stages of recruitment procedure

III etap

Application process at a foreign university.

- Completing all application documents required by a foreign university, including a **Learning Agreement** [LA].

Recruitment criteria.

Factors determining the position on the ranking list.

Bachelor

Students of First-cycle studies

- ▮ Average grade from the first year of studies **not less than 3.75!**
- ▮ Additional points.

Master

Students of Second-cycle studies

- ▮ Average grade from the third year of studies **not less than 3,75!**
- ▮ Additional points.

Additional points.

a gratification for extracurricular activity.

I type

Distinctive language skills

- ▮ Certified knowledge of a **foreign language**.
- ▮ Not necessarily the language of the country you are going to travel to.
- ▮ **An internationally recognized certificate.**
- ▮ Maximum number of points:

0,05 pkt

Additional points.

a gratification for extracurricular activity.

II type

Social activity.

- ▮ Documented activity for the faculty or polytechnic community: active member of the student government, ESN, etc.
- ▮ **Volunteering in non-university institutions.**
- ▮ Maximum number of points:

0,05 pkt

Additional points.

a gratification for extracurricular activity.

III type

Scientific / sports activities.

- ▮ Achievements in architectural and art competitions.
- ▮ Documented activity in scientific clubs or non-associated scientific activity.
- ▮ Sports achievements in the clubs of the Poznań University of Technology.
- ▮ Maximum number of points:

0,05 pkt

The Ranking List.

Summary

Bachelor i Master

Common ranking list

- ▮ **The sum of the average for studies and additional points** determines the place on the ranking list.
- ▮ The ranking list determines **the priority of nomination** to foreign universities in accordance with the preferences indicated by the student.

average grade +
max. 0,15

Other issues::

- ▮ **Finances,**
- ▮ **Catering and accommodation,**
- ▮ **Language in which the classes are conducted**

Stawki stypendium studia – PROJEKT 2023

GRUPA	Grupy krajów	ERASMUS+ (zawsze w EUR)
I	Dania, Finlandia, Irlandia, Islandia, Lichtenstein, Luksemburg, Norwegia, Szwecja oraz Szwajcaria, Wielka Brytania, Wyspy Owcze	670,00
II	Austria, Belgia, Cypr, Francja, Grecja, Hiszpania, Malta, Niderlandy, Niemcy, Portugalia, Włochy oraz Andora, Monako, San Marino, Watykan	670,00
III	Bułgaria, Chorwacja, Czechy, Estonia, Litwa, Łotwa, Republika Macedonii Północnej, Rumunia, Serbia, Słowacja, Słowenia, Turcja, Węgry	600,00

Mobility at the Faculty of Architecture

Mobilność studentów i pracowników uczelni między:

Mobility of university students and staff between:

- **Erasmus+ KA171** - krajami programu i **krajami partnerskimi.**
– program and partner countries.



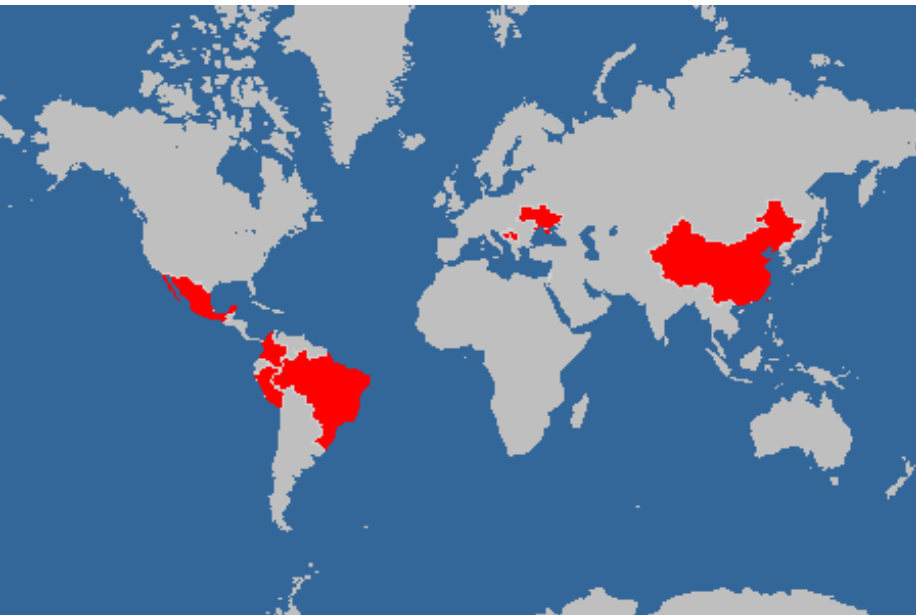

Bilateral Agreements with partners from:

- ▣ China,
- ▣ Peru,
- ▣ Brasil,
- ▣ Colombia,
- ▣ Mexico,
- ▣ Taiwan,
- ▣ Israel,
- ▣ Ukraine,
- ▣ Serbia and Montenegro,
- ▣ Bosnia and Herzegovina,

*Guilin University of Technology



WYDZIAŁ ARCHITEKTURY

ul. Nieszawska 13 C, 61-021 Poznan, Poland
tel: 0048 61 665 3255, fax: 0048 61 665 3300
office_darf@put.poznan.pl architektura.put.poznan.pl

Faculty recruitment

study exchange in the academic year 2024-25

22.01.2024

Deadline for AF at FA PUT